

K-PSK Square Plate Wall Mounted Axial Fan

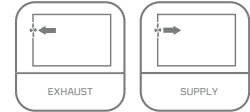

K-PSK is wall-window type axial fan which is used for extracting poorly polluted air indoor spaces or supplying fresh air from outside between min. 1.300m³/h and max. 8.200m³/h air flow range. Blades are designed for quiet and high air flow rate and it has protection grill on both side. It is suitable for industrial ventilation of large volume places such as factory, warehouse, farms, paint shop, welding shops etc.



MOTOR INSULATION CLASS	B CLASS
MOTOR PROTECTION CLASS	IP 54
MOTOR EFFICIENCY CLASS	IE1-IE2
MOTOR ENCLOSURE TYPE	TEFC
MOTOR BRAND	KALVENT
BODY MATERIAL	SHEET METAL
BODY COATING	ELECTROSTATIC POWDER PAINT
IMPELLER MATERIAL	SHEET METAL
DUTY CYCLE	IEC Duty Cycle-S1
WORKING AMBIENT TEMPERATURE	-20 +50 °C
DIRECTIVE	IEC-60335-2-80, ISO 1940-1

MODEL	VOLTAGE (V)	FREQUENCY (Hz)	POWER (W)	REVOLUTION (rpm)	FLOW RATE (m ³ /h)	NOISE LEVEL (dB(A))	PRICE
K-PSK 250 2A	230 or 380	50	180	2.900	2.200	72	
K-PSK 250	230 or 380	50	120	1.460	1.300	54	
K-PSK 300	230 or 380	50	130	1.450	2.250	55	
K-PSK 350	230 or 380	50	155	1.425	3.250	59	
K-PSK 400	230 or 380	50	185	1.410	4.600	62	
K-PSK 450	230 or 380	50	210	1.390	5.600	66	
K-PSK 500	230 or 380	50	225	1.375	7.150	70	
K-PSK 600	230 or 380	50	250	1.375	8.200	72	

Values are for 0 Pa.

DRAWING

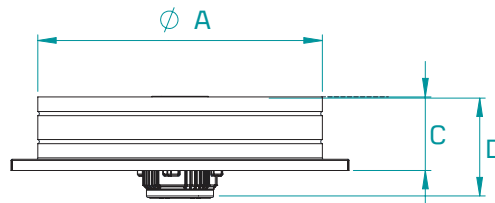
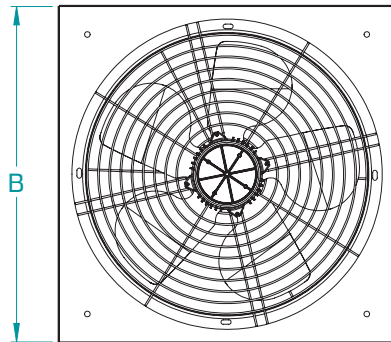

MODEL	A (mm)	B (mm)	C (mm)	D (mm)
K-PSK 250	265	350	113	173
K-PSK 300	325	400	113	173
K-PSK 350	375	450	113	173
K-PSK 400	405	500	115	180

MODEL	A (mm)	B (mm)	C (mm)	D (mm)
K-PSK 450	455	550	115	180
K-PSK 500	505	600	115	180
K-PSK 600	605	700	115	195

PERFORMANCE CURVES

K-PSK 250

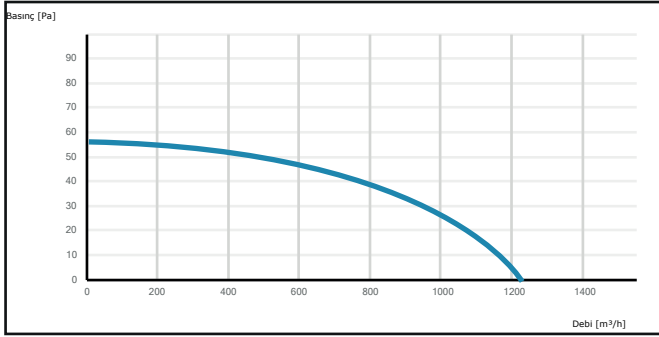

K-PSK 250 2A

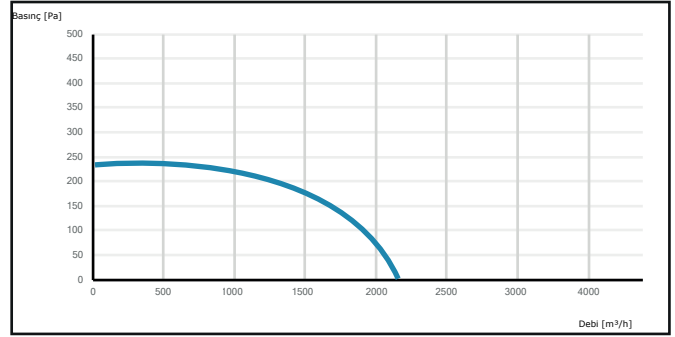

K-PSK 300

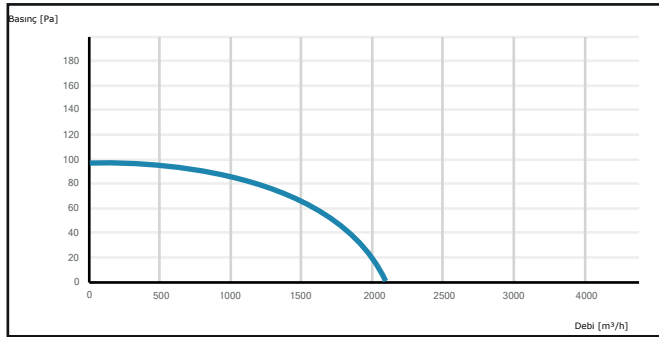

K-PSK 350

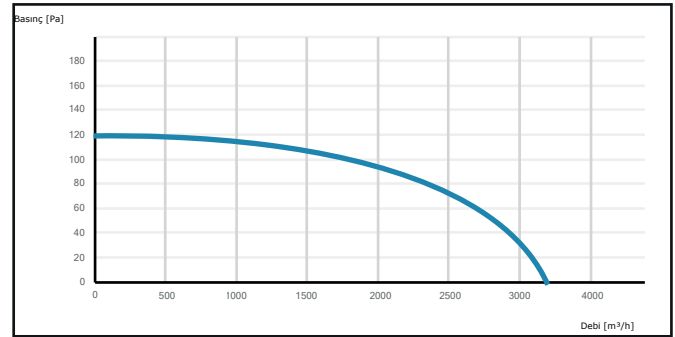

K-PSK 400

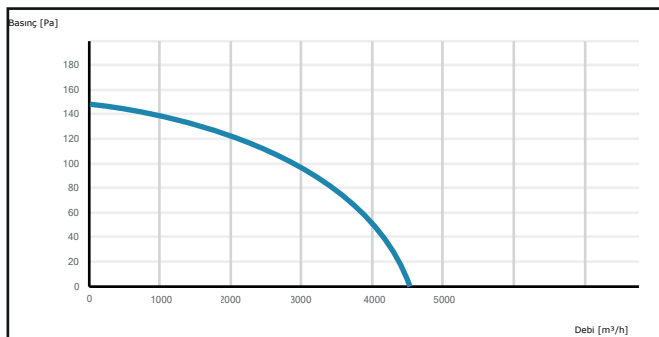

K-PSK 450

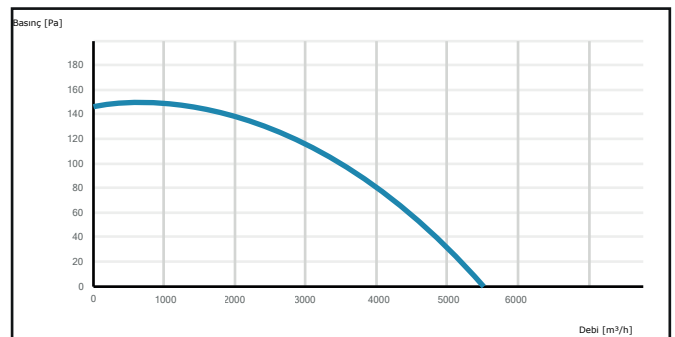

K-PSK 500

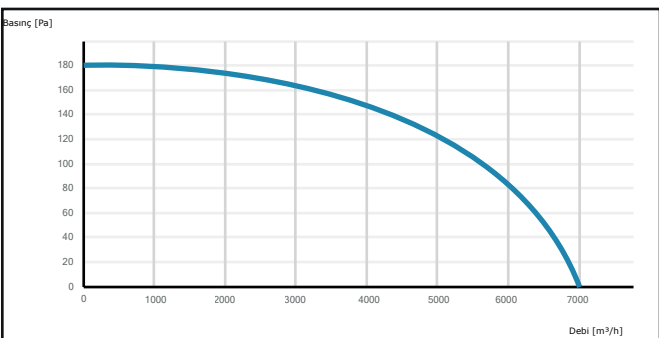

K-PSK 600

